

## TUBULAR BUTT-CONNECTOR TYPE-SP, SB, S-L

- Material : Electrolytic Copper
- Surface : Tin Plated

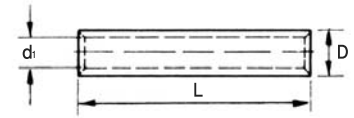
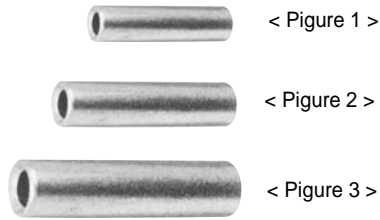

Part Number (Figure 1)	L	Part Number (Figure 2)	L	Part Number (Figure 3)	L	Wire Range		d <sub>1</sub>	D
						AWG	mm <sup>2</sup>		
JSP 007	7.5	JSB 007	15	JS 007L	30	20~18	0.75	1.6	2.4
JSP 015	7.5	JSB 015	15	JS 015L	30	18~16	1.5	2.0	3.0
JSP 025	7.5	JSB 025	15	JS 025L	30	16~14	2.5	2.5	3.5
JSP 04	7.5	JSB 04	15	JS 04L	30	14~12	4	3.2	4.5
JSP 06	7.5	JSB 06	15	JS 06L	30	12~10	6	4.0	5.5
JSP 10	10	JSB 10	20	JS 10L	40	8	10	4.7	6.7
JSP 16	12	JSB 16	24	JS 16L	48	6	16	5.4	7.4
JSP 25	14	JSB 25	28	JS 25L	56	4~3	25	6.7	9.0
JSP 35	15	JSB 35	30	JS 35L	60	2	35	8.1	10.6
JSP 50	16	JSB 50	32	JS 50L	64	1~1/0	50	9.5	12
JSP 70	18	JSB 70	36	JS 70L	72	2/0	70	11.3	14.6
JSP 95	19.5	JSB 95	39.5	JS 95L	78	3/0~4/0	95	13.5	17
JSP 120	21	JSB 120	42	JS 120L	82	250Kcmil	120	15.2	19
JSP 150	27	JSB 150	54	JS 150L	108	300Kcmil	150	17	21
JSP 185	32.5	JSB 185	65	JS 185L	130	350Kcmil	185	19	23.5
JSP 240	34	JSB 240	68	JS 240L	136	500Kcmil	240	22	27.4
JSP 300	37	JSB 300	74	JS 300L	148	600Kcmil	300	24	30.5
JSP 400	44	JSB 400	88	JS 400L	176	750Kcmil	400	26	34
JSP 500	49	JSB 500	98	JS 500L	196	1000Kcmil	500	31	40
JSP 630	60	JSB 630	120	JS 630L	240	1200Kcmil	630	34	45

\*Crimping Tool : See Chart Page C2~C18

## NON-INSULATED BUTT SPLICE-FUNNEL ENTRY TYPE-JSFE

- Material : Electrolytic Copper
- Surface : Tin plated
- Internal wire stop to prevent Over-insertion of Conductor.

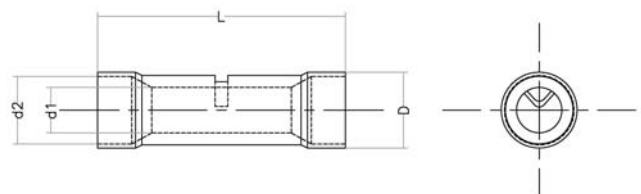

Part Number	Wire Range		Dimension (mm)			
	AWG	Stranded (mm <sup>2</sup> )	D	d1	d2	L
JSFE 15	22~16	1.25~1.5	4.3	1.8	3.1	22
JSFE 25	16~14	2~2.5	4.6	2.4	3.6	22
JSFE 6	12~10	4~6	6.4	3.6	5.0	23