

TWM,HDM

INSTALLATION TOOLS

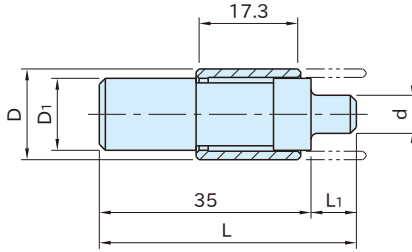

Body
Steel(SUJ2)
Quenched and tempered
Black oxide finish

Type	Part Number	L	D	d	D ₁	L ₁	Weight (g)	Keylocking Inserts	
								Carbon Steel	Stainless Steel
THIN WALL	TWM 5	42.5	11	3.8	7.8	7.5	19	KIC0508	KIC0508-SUS
	TWM 6		13	4.6	9.9		27	KIC0610	KIC0610-SUS
	TWM 8		15	6.3	11.9		38	KIC0812	KIC0812-SUS
	TWM10		17	8.1	13.9		51	KIC1014	KIC1014-SUS
	TWM12	45	19	9.8	15.8	10	65	KIC1216	KIC1216-SUS
HEAVY DUTY	HDM 4	42.5	11	3	7.8	7.5	18	KIC0408	KIC0408-SUS
	HDM 5		13	3.8	9.9		26	KIC0510	KIC0510-SUS
	HDM 6		15	4.6	11.9		37	KIC0612	KIC0612-SUS
	HDM 8		17	6.3	13.9		50	KIC0814	KIC0814-SUS
	HDM10		19	7.6	15.8		64	KIC1016	KIC1016-SUS
	HDM12	45	21	9.8	17.9	10	82	KIC1218	KIC1218-SUS
	HDM16		25	13.5	21.9		123	KIC1622	KIC1622-SUS
	HDM20		33	16.9	29.9		221	KIC2030	KIC2030-SUS
	HDM24		36	20.4	32.9		270	KIC2433	KIC2433-SUS