

# SH

# SPEED HANDLES



**SH-R**  
(Reamed)



**SH-C**  
(Bored)



**SH-T**  
(Tapped)

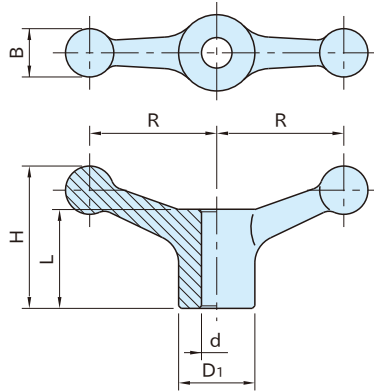

**SH-R**  
(Reamed)

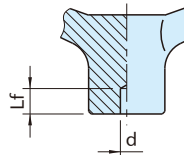

**SH-C**  
(Bored)

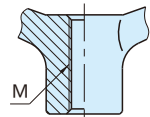

**SH-T**  
(Tapped)

**Body & Lever**

Ductile cast iron (FCD450)  
Powder baked finish  
Black

Type / Size	R	B	H	D <sub>1</sub>	L	Reamed	Bored		Tapped
						d (H8)	d	Lf	M
<b>SH-R</b> 50	50	19	56	30	39	12	5	10	M12×1.75
<b>SH-C</b> 63	63	22	66	38	44	16			M16×2
<b>SH-T</b> 76	76	25	75	45	49	20			M20×2.5

Reamed		Bored		Tapped	
Part Number	Weight (g)	Part Number	Weight (g)	Part Number	Weight (g)
<b>SH50R</b>	305	<b>SH50C</b>	325	<b>SH50T</b>	310
<b>SH63R</b>	485	<b>SH63C</b>	550	<b>SH63T</b>	500
<b>SH76R</b>	810	<b>SH76C</b>	905	<b>SH76T</b>	820