

# QLRCS

# Clamping Bars

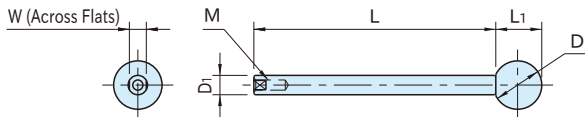

Part Number	D <sub>1</sub> (f8)	L	L <sub>1</sub>	D	W	M	Weight (g)
<b>QLRCS-08100</b>	8	100	19	20	7	M4×0.7 8 deep	50
<b>QLRCS-08125</b>		125					60
<b>QLRCS-08150</b>		150					70
<b>QLRCS-12125</b>	12	125	24	25	10	M6×1 12 deep	130
<b>QLRCS-12150</b>		150					150
<b>QLRCS-12200</b>		200					190

Arm	Ball Knob
Steel (S45C)	ABS resin
Chrome plated	Black

## How To Use

Can be cut shorter to a desired length.

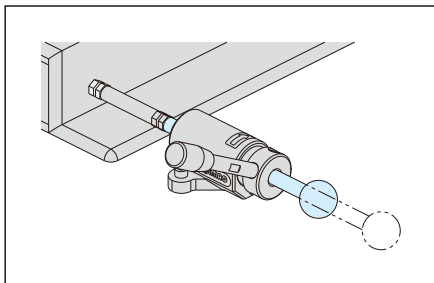

## Reference

**QLRC** THRUST CLAMPS

**QLRCF** THRUST CLAMPS (Vertical)