

# OGL LEVER ARMS

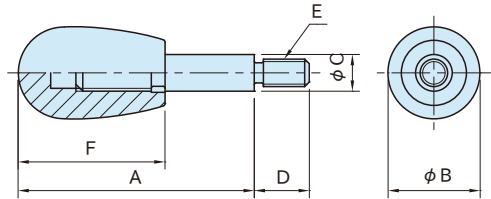

ELESA:BL.368



Type	Knob	Arm
<b>OGL</b>	Polyamide plastic Glossy Finish Black	Steel (SS400) Hard chrome plated finish Satin finish Silver matte
<b>OGL-SUS</b>		Stainless steel (SUS303)

Steel Part Number	Stainless Steel Part Number	A	B	C	D	E	F	Weight (g)
<b>OGL 6× 63</b>	<b>OGL 6× 63-SUS</b>	63	20	8	12	M 6×1	32	32
<b>OGL 6× 80</b>	<b>OGL 6× 80-SUS</b>	80						39
<b>OGL 6×100</b>	<b>OGL 6×100-SUS</b>	100						47
<b>OGL 8× 80</b>	<b>OGL 8× 80-SUS</b>	80	26	10	20	M 8×1.25	42	69
<b>OGL 8×100</b>	<b>OGL 8×100-SUS</b>	100						81
<b>OGL 8×125</b>	<b>OGL 8×125-SUS</b>	125						97
<b>OGL10×100</b>	<b>OGL10×100-SUS</b>	100	34	12	25	M10×1.5	54.5	132
<b>OGL10×125</b>	<b>OGL10×125-SUS</b>	125						154
<b>OGL10×160</b>	<b>OGL10×160-SUS</b>	160						185
<b>OGL12×125</b>	<b>OGL12×125-SUS</b>	125		14	30	M12×1.75		245
<b>OGL12×160</b>	<b>OGL12×160-SUS</b>	160						315
<b>OGL12×200</b>	<b>OGL12×200-SUS</b>	200						

• Working temperature : Between -20°C and 90°C