

CP720

FLEX LOCATOR PINS

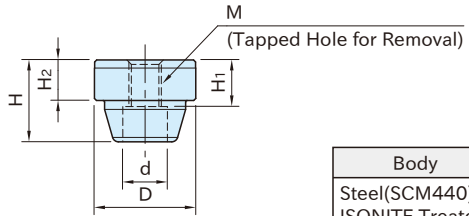

Body
Steel(SCM440)
ISONITE Treated (Nitrocarburized)

Part Number	D (g6)	H ₂	H	M	H ₁	d	Weight (g)	Proper Flex Locator Bushings
CP720-16032	16	5.5	11.5	M 5×0.8 (Prepared Hole φ 4.2)	6	8	18	CP725-16032
CP720-25050	25	10	20	M 8×1.25 (Prepared Hole φ 6.8)	11.5	11	49	CP725-25050
CP720-38070	38	15	29.5	M10×1.5 (Prepared Hole φ 8.5)	18	14	176	CP725-38070
CP720-56095	56	22	43.5	M16×2 (Prepared Hole φ 14)	28.5	20	569	CP725-56095

How To Use

Mouting Hole Dimensions

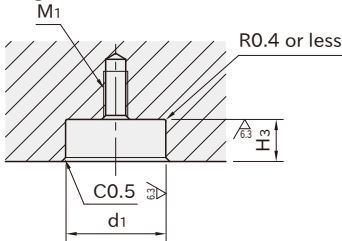

Part Number	d ₁ (H7)	H ₃ (±0.05)	M ₁
CP720-16032	16	6	M 4×0.7
CP720-25050	25	10.5	M 6×1
CP720-38070	38	15.5	M 8×1.25
CP720-56095	56	22.5	M12×1.75

Spacing Tolerance



How to Install and Remove

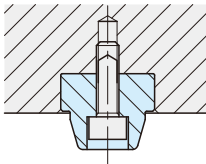

Use a socket-head cap screw to fix the flex locator pin.

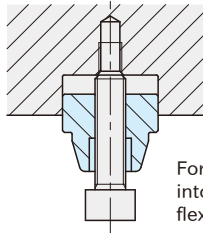

For removal, insert a screw into the tapped hole of the flex locator pin and screw it.

Reference

- Mechanism of FLEX LOCATORS
- How To Install FLEX LOCATORS (Blind)
- How To Use FLEX LOCATORS (Blind)