

# CP155-L

## TAPERED CLAMPING SCREWS (Round)

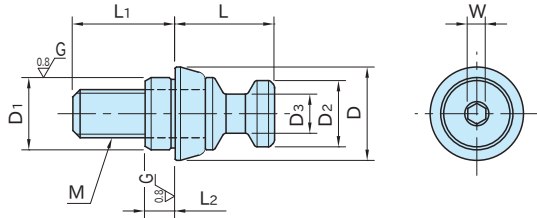

Tapered Bushing	Clamping Screw
S45C steel Black oxide finished Precision ground	SCM435 steel Quenched and tempered Black oxide finished

Part Number	M	D <sub>1</sub> (g6)	L <sub>2</sub>	L <sub>1</sub>	D	L	D <sub>2</sub>	D <sub>3</sub>	W	Weight (g)
<b>CP155-08001L</b>	M 8×1.25	12	5	17	15.5	16.5	11	6.5	3	20
<b>CP155-12001L</b>	M12×1.75	18	6	24	24.5	25	16	9.5	5	70
<b>CP155-16001L</b>	M16×2	22	7.5	30	31.5	33	21	13	6	150

# CP155-D

## TAPERED CLAMPING SCREWS (Diamond)

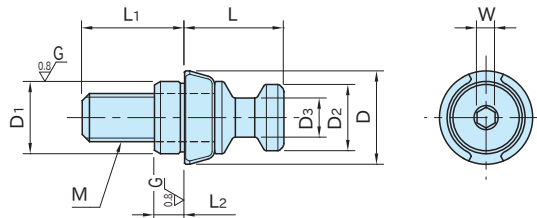

Tapered Bushing	Clamping Screw
S45C steel Black oxide finished Precision ground	SCM435 steel Quenched and tempered Black oxide finished

Part Number	M	D <sub>1</sub> (g6)	L <sub>2</sub>	L <sub>1</sub>	D	L	D <sub>2</sub>	D <sub>3</sub>	W	Weight (g)
<b>CP155-08001D</b>	M 8×1.25	12	5	17	15.5	16.5	11	6.5	3	20
<b>CP155-12001D</b>	M12×1.75	18	6	24	24.5	25	16	9.5	5	70
<b>CP155-16001D</b>	M16×2	22	7.5	30	31.5	33	21	13	6	150