

# CBWP

# LOBE KNOB CLAMP SCREWS

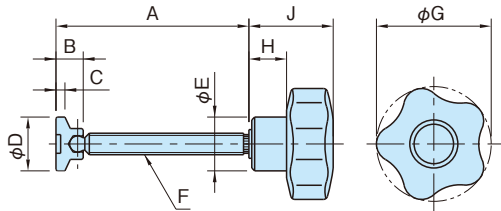

Knob	Screw	Pad
Polypropylene plastic Black matte	Steel (SUM22L) Black oxide finish	Polyamide (6 nylon) plastic Black

Part Number	A	B	C	D	E	F	G	H	J	Weight (g)
<b>CBWP06053</b>	53.8	7.6	2.5	15	15	M 6×1	32	10	23	23
<b>CBWP08064</b>	64.6	9	3.5	18	17	M 8×1.25	40	12	27	52
<b>CBWP10070</b>	70.1	11	4	21	19	M10×1.5	50	14	32	80
<b>CBWP12086</b>	86	13	5	25	22	M12×1.75	63	16	37	131

## Features:

- The plastic pad allows clamping a soft-material workpiece.  
Comes with a STK-N knob.
- The knob is glued to the screw.

## How To Use

The plastic pad is not fitted to the screw when shipped. It can be fitted by pushing over the screw's ball end.