

ALHK

ALUMINUM HAND KNOBS

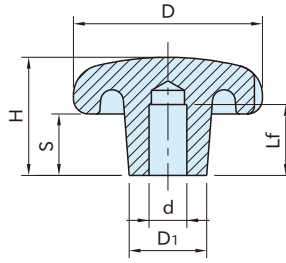

ALHK-R
(Reamed)

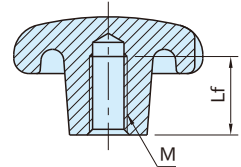

ALHK-T
(Tapped)

Body
Aluminum alloy(AC4B)
Buffed finish

Part Number		D	H	D ₁	S	d (H9)	M	Lf	Weight (g)
Reamed	Tapped								
ALHK40R	ALHK40T	40	25	14	13	8	M 8×1.25	15	35
ALHK50R	ALHK50T	50	32	18	17	10	M10×1.5	18	65
ALHK63R	ALHK63T	63	40	20	21	12	M12×1.75	22	100
ALHK80R	ALHK80T	80	50	25	25	16	M16×2	28	220

Notes

Dimensions are subject to slight variations due to buffed finish.