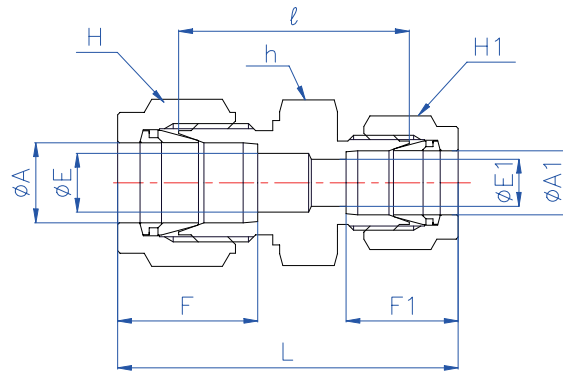

BI-LoK**MDUR****Reducing Union
Connects metric tube to fractional tube**

Part No.	A	A ₁		E	E ₁	h	H	H ₁		ℓ	L	F	F ₁
	mm	in	mm	mm	mm	HEX	HEX	in	HEX	mm	mm	mm	mm
MDUR 3M-2	3	1/8	3.18	2.3	2.3	12	12	7/16	11.11	23.5	36.9	13.0	13.0
MDUR 4M-2	4	1/8	3.18	2.7	2.3	12	13	7/16	11.11	24.0	37.5	13.9	13.0
MDUR 4M-4	4	1/4	6.35	2.7	4.8	12	13	9/16	14.29	26.0	40.3	13.9	15.4
MDUR 4M-6	4	3/8	9.53	2.7	7.1	17	13	11/16	17.46	27.5	41.8	13.9	17.0
MDUR 6M-2	6	1/8	3.18	4.8	2.3	14	14	7/16	11.11	25.7	39.9	15.4	13.0
MDUR 6M-4	6	1/4	6.35	4.8	4.8	14	14	9/16	14.29	27.3	42.3	15.4	15.4
MDUR 6M-6	6	3/8	9.53	4.8	7.1	17	14	11/16	17.46	29.0	44.0	15.4	17.0
MDUR 8M-2	8	1/8	3.18	6.4	2.3	17	17	7/16	11.11	27.0	41.2	16.3	13.0
MDUR 8M-4	8	1/4	6.35	6.4	4.8	17	17	9/16	14.29	28.6	43.6	16.3	15.4
MDUR 8M-6	8	3/8	9.53	6.4	7.1	17	17	11/16	17.46	29.5	44.5	16.3	17.0
MDUR 8M-8	8	1/2	12.7	6.4	10.4	22	17	7/8	22.23	30.0	47.8	16.3	23.0
MDUR 10M-2	10	1/8	3.18	7.9	2.3	19	19	7/16	11.11	28.0	42.5	17.3	13.0
MDUR 10M-4	10	1/4	6.35	7.9	4.8	19	19	9/16	14.29	29.6	44.9	17.3	15.4
MDUR 10M-6	10	3/8	9.53	7.9	7.1	19	19	11/16	17.46	32.0	47.3	17.3	17.0
MDUR 10M-8	10	1/2	12.7	7.9	10.4	22	19	7/8	22.23	32.0	50.1	17.3	23.0
MDUR 12M-4	12	1/4	6.35	9.5	4.8	22	22	9/16	14.29	30.5	48.2	22.9	15.4
MDUR 12M-6	12	3/8	9.53	9.5	7.1	22	22	11/16	17.46	32.0	49.7	22.9	17.0
MDUR 12M-8	12	1/2	12.7	9.5	10.4	22	22	7/8	22.23	32.0	52.5	22.9	23.0
MDUR 12M-12	12	3/4	19.05	9.5	15.8	27	22	1-1/8	28.58	33.3	53.8	22.9	24.6
MDUR 16M-4	16	1/4	6.35	12.7	4.8	24	27	9/16	14.29	31.9	49.6	24.5	15.4
MDUR 16M-8	16	1/2	12.7	12.7	10.4	24	27	7/8	22.23	33.5	54.0	24.5	23.0
MDUR 16M-10	16	5/8	15.88	12.7	12.7	24	27	1	25.4	33.5	54.0	24.5	24.6
MDUR 16M-12	16	3/4	19.05	12.7	15.8	27	27	1-1/8	28.58	33.5	54.0	24.5	24.6
MDUR 18M-12	18	3/4	19.05	15.1	15.8	27	30	1-1/8	28.58	33.3	53.8	24.5	24.6
MDUR 20M-12	20	3/4	19.05	16.5	15.8	30	30	1-1/8	28.58	35.1	55.6	24.5	24.6