

NPT AMERICAN TAPER PIPE TAPS for NPT THREADS

美制NPT螺纹用锥管丝锥

► Suitable for process Taper pipe internal threads.
NPT : American Taper pipe threads (for mechanical joints)

► 适用于加工锥管内螺纹。
NPT : 美制锥管螺纹 (机械连接用)



Hole type
孔类型
2.0×D

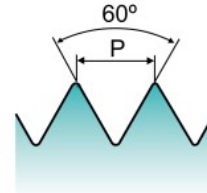
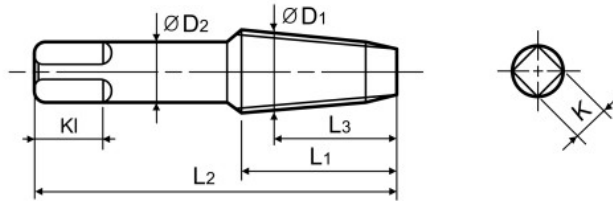
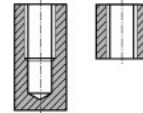

Material groups: **GS** HSS-E NPT ANSI G 60° 3.0P Bright p. B201

Recommended ToolHolder: Plain Shank TAPPING ER CHUCK Page D215-220
TAPPING CHUCK D221-228
ONE STEP TAPPING CHUCK D211-213

Unit(单位) : mm

SIZE	TPI	EDP No.	Limit	Basic Maj. Dia.	Overall Length	Thread Length	Projection Length	Shank Diameter	Square Size	Square Length	No. of Flute
尺寸	牙距	型号	精度	最大基准直径	全长	螺纹长	基准长度	柄径	方块尺寸	方块长度	槽数
ØD1					L2	L1	L3	ØD2	K	Kl	
NPT 1/16 - 27		T2527020	ANSI G	7.770	54	17	12.00	8	6	9	4
NPT 1/8 - 27		T2527200	ANSI G	10.117	55	19	12.05	8	6	9	4
NPT 1/4 - 18		T2527400	ANSI G	13.426	62	28	17.45	11	9	12	4
NPT 3/8 - 18		T2527480	ANSI G	16.866	65	28	17.65	14	11	14	4
NPT 1/2 - 14		T2527560	ANSI G	20.980	80	35	22.85	18	14	17	4
NPT 3/4 - 14		T2527700	ANSI G	26.325	85	35	22.95	23	17	20	5
NPT 1" - 11*1/2		T2527780	ANSI G	32.934	95	45	27.40	26	21	24	5

► Refer to p.B233-B238 for recommended tap drill sizes. 参考p.B233-B238 底孔尺寸.

◎ : Excellent (优秀) ○ : Good (良好)

ISO Material Description	P										M			K						
	Non-alloy steel					Low alloy steel					High alloyed steel, and tool steel			Stainless steel			Grey cast iron		Nodular cast iron	Malleable cast iron
VDI 3323	1	2	3	4	5	6	7	8	9	10	11	12	13	14	15	16	17	18	19	20
HRc	13	13	25	28	32	10	29	32	38	15	35	15	23	10	10	26	3	25		
HB	125	190	250	270	300	180	275	300	350	200	325	200	240	180	180	260	160	250	130	230
Recommended	◎	◎	◎			◎				○					○	○	○			

ISO Material Description	N					S					H										
	Aluminum-wrought alloy		Aluminum-cast, alloyed			Copper and Copper Alloys (Bronze / Brass)		Non Metallic Materials			Heat Resistant Super Alloys					Titanium Alloys		Hardened steel	Chilled Cast Iron	Hardened Cast Iron	
VDI 3323	21	22	23	24	25	26	27	28	29	30	31	32	33	34	35	36	37	38	39	40	41
HRc											15	30	25	38	34			55	60	42	55
HB	60	100	75	90	130	110	90	100			200	280	250	350	320	400Rm	1050Rm	550	630	400	550
Recommended	○	○	○			○	○														