

UCTU
Cylindrical bore (with set screws)
d 40 ~ 80 mm

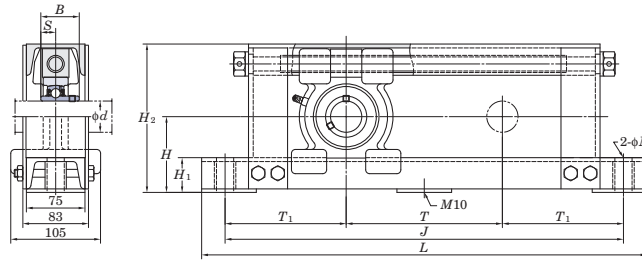

UCTU200

With Pressed Steel Cover With Cast Iron Cover

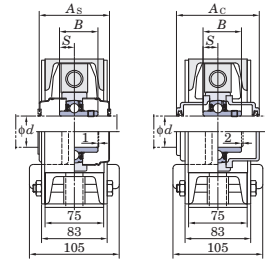

Shaft Dia. mm	Dimensions mm										Bolt Size mm	Standard		
	<i>d</i>	<i>H</i>	<i>H</i> ₁	<i>H</i> ₂	<i>L</i>	<i>J</i>	<i>N</i>	<i>T</i>	<i>T</i> ₁	<i>B</i>		<i>S</i>	Unit No.	Bearing No.
40	97	44	190	870	810	22	500	155	49.2	19	M18	UCTU208-500	UC208	21
	97	44	190	970	910	22	600	155	49.2	19	M18	UCTU208-600	UC208	22
	97	44	190	1,070	1,010	22	700	155	49.2	19	M18	UCTU208-700	UC208	24
	97	44	190	1,170	1,110	22	800	155	49.2	19	M18	UCTU208-800	UC208	26
	97	44	190	1,270	1,210	22	900	155	49.2	19	M18	UCTU208-900	UC208	28
45	102	44	200	880	820	22	500	160	49.2	19	M18	UCTU209-500	UC209	22
	102	44	200	980	920	22	600	160	49.2	19	M18	UCTU209-600	UC209	24
	102	44	200	1,080	1,020	22	700	160	49.2	19	M18	UCTU209-700	UC209	25
	102	44	200	1,180	1,120	22	800	160	49.2	19	M18	UCTU209-800	UC209	27
	102	44	200	1,280	1,220	22	900	160	49.2	19	M18	UCTU209-900	UC209	29
50	107	44	210	890	830	22	500	165	51.6	19	M18	UCTU210-500	UC210	23
	107	44	210	990	930	22	600	165	51.6	19	M18	UCTU210-600	UC210	25
	107	44	210	1,090	1,030	22	700	165	51.6	19	M18	UCTU210-700	UC210	27
	107	44	210	1,190	1,130	22	800	165	51.6	19	M18	UCTU210-800	UC210	28
	107	44	210	1,290	1,230	22	900	165	51.6	19	M18	UCTU210-900	UC210	30
55	115	44	230	910	850	22	500	175	55.6	22.2	M18	UCTU211-500	UC211	25
	115	44	230	1,010	950	22	600	175	55.6	22.2	M18	UCTU211-600	UC211	27
	115	44	230	1,110	1,050	22	700	175	55.6	22.2	M18	UCTU211-700	UC211	28
	115	44	230	1,210	1,150	22	800	175	55.6	22.2	M18	UCTU211-800	UC211	30
	115	44	230	1,310	1,250	22	900	175	55.6	22.2	M18	UCTU211-900	UC211	32
60	120	44	240	920	860	22	500	180	65.1	25.4	M18	UCTU212-500	UC212	26
	120	44	240	1,020	960	22	600	180	65.1	25.4	M18	UCTU212-600	UC212	28
	120	44	240	1,120	1,060	22	700	180	65.1	25.4	M18	UCTU212-700	UC212	30
	120	44	240	1,220	1,160	22	800	180	65.1	25.4	M18	UCTU212-800	UC212	31
	120	44	240	1,320	1,260	22	900	180	65.1	25.4	M18	UCTU212-900	UC212	33
65	145	55	285	940	880	22	500	190	75	30	M18	UCTU313-500	UC313	40
	145	55	285	1,040	980	22	600	190	75	30	M18	UCTU313-600	UC313	43
	145	55	285	1,140	1,080	22	700	190	75	30	M18	UCTU313-700	UC313	46
	145	55	285	1,240	1,180	22	800	190	75	30	M18	UCTU313-800	UC313	49
	145	55	285	1,340	1,280	22	900	190	75	30	M18	UCTU313-900	UC313	51
70	150	55	295	960	900	22	500	200	78	33	M18	UCTU314-500	UC314	44
	150	55	295	1,060	1,000	22	600	200	78	33	M18	UCTU314-600	UC314	46
	150	55	295	1,160	1,100	22	700	200	78	33	M18	UCTU314-700	UC314	48
	150	55	295	1,260	1,200	22	800	200	78	33	M18	UCTU314-800	UC314	51
	150	55	295	1,360	1,300	22	900	200	78	33	M18	UCTU314-900	UC314	53
75	155	55	305	980	920	22	500	210	82	32	M18	UCTU315-500	UC315	54
	155	55	305	1,080	1,020	22	600	210	82	32	M18	UCTU315-600	UC315	57
	155	55	305	1,180	1,120	22	700	210	82	32	M18	UCTU315-700	UC315	59
	155	55	305	1,280	1,220	22	800	210	82	32	M18	UCTU315-800	UC315	61
	155	55	305	1,380	1,320	22	900	210	82	32	M18	UCTU315-900	UC315	64
80	160	55	315	1,000	940	22	500	220	86	34	M18	UCTU316-500	UC316	57
	160	55	315	1,100	1,040	22	600	220	86	34	M18	UCTU316-600	UC316	60
	160	55	315	1,200	1,140	22	700	220	86	34	M18	UCTU316-700	UC316	62
	160	55	315	1,300	1,240	22	800	220	86	34	M18	UCTU316-800	UC316	64
	160	55	315	1,400	1,340	22	900	220	86	34	M18	UCTU316-900	UC316	67

- Remarks
1. In Part No. of unit and units with covers, fitting codes follow bore diameter numbers. (See Table 10.5 in P.62.)
 2. Part No. of applicable grease fittings are shown below.
 C-1/4-28UNF..... 208~210
 C-R1/8..... 211, 212, 313~318
 3. As for the triple seal type product, suffix code L3 follows the Part No. of unit or bearing.
 (Example of Part No. : UCTU208JL3-500, UC208L3)