

UFL
Cylindrical bore (with set screws)
d 8 ~ 30 mm

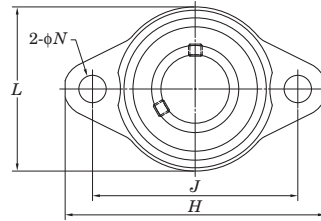
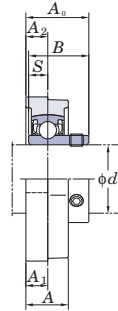

Shaft Dia. mm	Dimensions										Bolt Size	Standard		
	inch mm											Unit No.	Housing No.	Bearing No.
<i>d</i>	<i>H</i>	<i>L</i>	<i>A</i>	<i>J</i>	<i>N</i>	<i>A</i> ₁	<i>A</i> ₂	<i>A</i> ₀	<i>B</i>	<i>S</i>	inch mm			
8	1 7/8	1 1/16	11/32	1 29/64	3/16	5/32	5/32	1/2	0.472	0.1378	No.8	UFL08	FL08	SU08
	48	27	8.5	37	4.8	4	4	12.5	12	3.5	M4			
10	2 3/8	1 13/32	15/32	1 49/64	9/32	1/4	15/64	5/8	0.591	0.197	1/4	UFL000	FL000	SU000
	60	36	12	45	7	6	6	16	15	5	M6			
12	2 15/32	1 1/2	15/32	1 57/64	9/32	1/4	15/64	5/8	0.591	0.197	1/4	UFL001	FL001	SU001
	63	38	12	48	7	6	6	16	15	5	M6			
15	2 5/8	1 21/32	1/2	2 3/32	9/32	1/4	1/4	11/16	0.650	0.217	1/4	UFL002	FL002	SU002
	67	42	13	53	7	6.5	6.5	17.5	16.5	5.5	M6			
17	2 25/32	1 13/16	9/16	2 13/64	9/32	9/32	9/32	23/32	0.689	0.236	1/4	UFL003	FL003	SU003
	71	46	14	56	7	7	7	18.5	17.5	6	M6			
20	3 17/32	2 5/32	5/8	2 51/64	13/32	5/16	5/16	7/8	0.827	0.276	5/16	UFL004	FL004	SU004
	90	55	16	71	10	8	8	22	21	7	M8			
25	3 3/4	2 3/8	5/8	2 61/64	13/32	5/16	5/16	29/32	0.866	0.276	5/16	UFL005	FL005	SU005
	95	60	16	75	10	8	8	23	22	7	M8			
30	4 13/32	2 3/4	23/32	3 11/32	1/2	11/32	23/64	1 1/32	0.965	0.295	3/8	UFL006	FL006	SU006
	112	70	18	85	13	9	9	26	24.5	7.5	M10			

Remarks 1. In Part No. of unit and units with covers, fitting codes follow bore diameter codes. (See Table 10.5 in P.62.)
 2. For the dimensions and forms of applicable bearings, see the dimensional tables of ball bearing for unit.