

Stamped Steel Pillow Block Units

SBPP
Cylindrical bore
(with set screws)
 d 12 ~ 30 mm

SAPP
Cylindrical bore
(with eccentric locking collar)



SBPP



SAPP

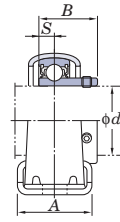

SBPP

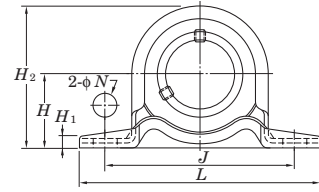

Shaft Dia		Dimensions								Bolt Size	Unit No.	Bearing No.
mm	inch	inch mm										
d		H	L	A	J	N	H_1	H_2	S	SBPP B	SAPP B_1	inch mm
12	$1/2$	$7/8$	$3\ 3/8$	$31/32$	$2\ 43/64$	$3/8$	$1/8$	$1\ 23/32$	0.236	0.866	1.122	$5/16$
		22.2	86	25	68	9.5	3.2	43.8	6	22	28.5	M8
15	$5/8$											
17												
20	$3/4$	1	$3\ 27/32$	$1\ 1/4$	$2\ 63/64$	$3/8$	$1/8$	2	0.276	0.984	1.161	$5/16$
		25.4	98	32	76	9.5	3.2	50.5	7	25	29.5	M8
25	$7/8$											
	$15/16$	$1\ 1/8$	$4\ 1/4$	$1\ 1/4$	$3\ 25/64$	$29/64$	$5/32$	$2\ 7/32$	0.295	1.063	1.201	$3/8$
	1	28.6	108	32	86	11.5	4	56.6	7.5	27	30.5	M10
30	$1\ 1/8$											
	$1\ 3/16$	$1\ 5/16$	$4\ 19/32$	$1\ 1/2$	$3\ 3/4$	$29/64$	$5/32$	$2\ 5/8$	0.315	1.181	1.335	$3/8$
	$1\ 1/4$	33.3	117	38	95	11.5	4	66.3	8	30	33.9	M10

Remark For the dimensions and forms of applicable bearings, see the dimensional tables of ball bearing for unit.