

印ろう付き丸フランジ形ユニット UCFC 200

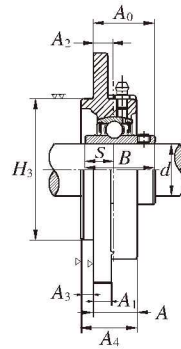

SR タイプシール

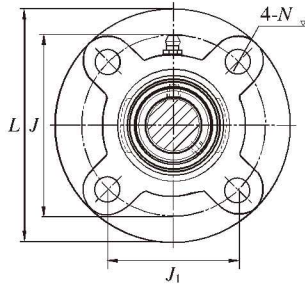

TRL タイプシール

軸径 (mm) (inch) <i>d</i>	寸 法 (mm)														取付けボルト の呼び (mm) (inch)		ユニット 呼び番号	適 用 軸受箱	軸 受 呼び番号	質 量 (kg)
	<i>L</i>	<i>J</i>	<i>J</i> ₁	<i>A</i> ₂	<i>A</i> ₄	<i>N</i>	<i>A</i> ₃	<i>A</i> ₁	<i>A</i>	<i>H</i> ₃	<i>A</i> ₀	<i>B</i>	<i>S</i>	(mm)	(inch)					
12 1/2	100	78	55.1	10	25.5	12	5	7	20.5	62	28.3	31.0	12.7	M10	3/8	UCFC201 UCFC201-8	FC201	UC201 UC201-8	0.78	
15 5/8	100	78	55.1	10	25.5	12	5	7	20.5	62	28.3	31.0	12.7	M10	3/8	UCFC202 UCFC202-10	FC202	UC202 UC202-10	0.78	
17 11/16	100	78	55.1	10	25.5	12	5	7	20.5	62	28.3	31.0	12.7	M10	3/8	UCFC203 UCFC203-11	FC203	UC203 UC203-11	0.78	
20 3/4	100	78	55.1	10	25.5	12	5	7	20.5	62	28.3	31.0	12.7	M10	3/8	UCFC204-12 UCFC204	FC204	UC204-12 UC204	0.78	
25 7/8 15/16 1	115	90	63.6	10	27.0	12	6	7	21.0	70	29.7	34.0	14.3	M10	3/8	UCFC205-14 UCFC205-15 UCFC205 UCFC205-16	FC205	UC205-14 UC205-15 UC205 UC205-16	0.95	
30 1 1/8 1 3/16 1 1/4	125	100	70.7	10	31.0	12	8	8	23.0	80	32.2	38.1	15.9	M10	3/8	UCFC206-18 UCFC206 UCFC206-19 UCFC206-20	FC206	UC206-18 UC206 UC206-19 UC206-20	1.40	
35 1 1/4 1 5/16 1 3/8 1 7/16	135	110	77.8	11	34.0	14	8	9	26.0	90	36.4	42.9	17.5	M12	7/16	UCFC207-20 UCFC207-21 UCFC207-22 UCFC207 UCFC207-23	FC207	UC207-20 UC207-21 UC207-22 UC207 UC207-23	1.70	
40 1 1/2 1 9/16	145	120	84.8	11	36.0	14	10	9	26.0	100	41.2	49.2	19.0	M12	7/16	UCFC208-24 UCFC208-25 UCFC208	FC208	UC208-24 UC208-25 UC208	2.00	
45 1 5/8 1 11/16 1 3/4	160	132	93.3	10	38.0	16	12	14	26.0	105	40.2	49.2	19.0	M14	1/2	UCFC209-26 UCFC209-27 UCFC209-28 UCFC209	FC209	UC209-26 UC209-27 UC209-28 UC209	2.80	
50 1 7/8 1 15/16	165	138	97.6	10	40.0	16	12	14	28.0	110	42.6	51.6	19.0	M14	1/2	UCFC210-30 UCFC210-31 UCFC210	FC210	UC210-30 UC210-31 UC210	3.00	
55 2 2 1/8 2 3/16	185	150	106.1	13	43.0	19	12	15	31.0	125	46.4	55.6	22.2	M16	5/8	UCFC211-32 UCFC211-34 UCFC211 UCFC211-35	FC211	UC211-32 UC211-34 UC211 UC211-35	4.00	
60 2 1/4 2 3/8 2 7/16	195	160	113.1	17	48.0	19	12	15	36.0	135	56.7	65.1	25.4	M16	5/8	UCFC212-36 UCFC212 UCFC212-38 UCFC212-39	FC212	UC212-36 UC212 UC212-38 UC212-39	4.70	
65 2 1/2	205	170	120.2	16	50.0	19	14	15	36.0	145	55.7	65.1	25.4	M16	5/8	UCFC213-40 UCFC213	FC213	UC213-40 UC213	5.40	
70 2 3/4	215	177	125.1	17	54.0	19	14	18	40.0	150	61.4	74.6	30.2	M16	5/8	UCFC214-44 UCFC214	FC214	UC214-44 UC214	6.80	
75 3	220	184	130.1	18	56.0	19	16	18	40.0	160	62.5	77.8	33.3	M16	5/8	UCFC215 UCFC215-48	FC215	UC215 UC215-48	7.30	
80	240	200	141.4	18	58.0	23	16	18	42.0	170	67.3	82.6	33.3	M20	3/4	UCFC216	FC216	UC216	8.90	
85 3 1/4	250	208	147.1	18	63.0	23	18	20	45.0	180	69.6	85.7	34.1	M20	3/4	UCFC217-52 UCFC217	FC217	UC217-52 UC217	10.40	
90 3 1/2	265	220	155.5	22	68.0	23	18	20	50.0	190	78.3	96.0	39.7	M20	3/4	UCFC218-56 UCFC218	FC218	UC218-56 UC218	13.00	