

POWERFULL®-SERIES

MALE RUN TEE

ティーエルユニオン (Rねじ)

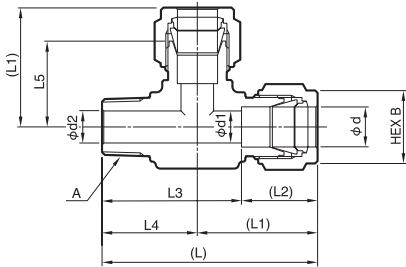
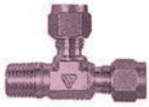

| ミリサイズ | 品番 | 呼び径 d | A | d1 | d2 | B | L | L1 | L2 | L3 | L4 | L5 |
|-------|-------------|-------|------|-----|-----|----|------|------|------|------|------|------|
| | PDWTL-3A-R | 3 | R1/8 | 2.4 | 4.8 | 10 | 41.2 | 23.4 | 12.7 | 28.5 | 17.8 | 17 |
| | PDWTL-3B-R | 3 | R1/4 | 2.4 | 4.8 | 10 | 47.8 | 24.4 | 12.7 | 35.1 | 23.4 | 18 |
| | PDWTL-4A-R | 4 | R1/8 | 2.4 | 4.8 | 12 | 42.1 | 24.3 | 13.6 | 28.5 | 17.8 | 17.8 |
| | PDWTL-4B-R | 4 | R1/4 | 2.4 | 4.8 | 12 | 47.7 | 24.3 | 13.6 | 34.1 | 23.4 | 17.8 |
| | PDWTL-6A-R | 6 | R1/8 | 4.8 | 4.8 | 14 | 45.6 | 26.8 | 15.2 | 30.4 | 18.8 | 19.6 |
| | PDWTL-6B-R | 6 | R1/4 | 4.8 | 4.8 | 14 | 50.2 | 26.8 | 15.2 | 35 | 23.4 | 19.6 |
| | PDWTL-6C-R | 6 | R3/8 | 4.8 | 4.8 | 14 | 55.8 | 29.6 | 15.2 | 40.6 | 26.2 | 22.4 |
| | PDWTL-6D-R | 6 | R1/2 | 4.8 | 4.8 | 14 | 64.6 | 31.6 | 15.2 | 49.4 | 33 | 24.4 |
| | PDWTL-8A-R | 8 | R1/8 | 6.4 | 4.8 | 16 | 50.7 | 29.9 | 16.2 | 34.5 | 20.8 | 22.4 |
| | PDWTL-8B-R | 8 | R1/4 | 6.4 | 6.4 | 16 | 55.3 | 29.9 | 16.2 | 39.1 | 25.4 | 22.4 |
| | PDWTL-8C-R | 8 | R3/8 | 6.4 | 6.4 | 16 | 56.8 | 30.6 | 16.2 | 40.6 | 26.2 | 23.1 |
| | PDWTL-8D-R | 8 | R1/2 | 6.4 | 6.4 | 16 | 65.6 | 32.6 | 16.2 | 49.4 | 33 | 25.1 |
| | PDWTL-10A-R | 10 | R1/8 | 7.9 | 4.8 | 19 | 56.9 | 33.3 | 17 | 39.9 | 23.6 | 25.9 |
| | PDWTL-10B-R | 10 | R1/4 | 7.9 | 7.1 | 19 | 61.5 | 33.3 | 17 | 44.5 | 28.2 | 25.9 |
| | PDWTL-10C-R | 10 | R3/8 | 7.9 | 7.9 | 19 | 61.5 | 33.3 | 17 | 44.5 | 28.2 | 25.9 |
| | PDWTL-10D-R | 10 | R1/2 | 7.9 | 7.9 | 19 | 66.3 | 33.3 | 17 | 49.3 | 33 | 25.9 |
| | PDWTL-12A-R | 12 | R1/8 | 9.5 | 4.8 | 22 | 59.3 | 35.7 | 22.5 | 36.8 | 23.6 | 25.9 |
| | PDWTL-12B-R | 12 | R1/4 | 9.5 | 7.1 | 22 | 63.9 | 35.7 | 22.5 | 41.4 | 28.2 | 25.9 |
| | PDWTL-12C-R | 12 | R3/8 | 9.5 | 9.5 | 22 | 63.9 | 35.7 | 22.5 | 41.4 | 28.2 | 25.9 |
| | PDWTL-12D-R | 12 | R1/2 | 9.5 | 9.5 | 22 | 68.7 | 35.7 | 22.5 | 46.2 | 33 | 25.9 |

※NPTねじ (アメリカ管用ねじ) も製作しております。

| インチサイズ | 品番 | 呼び径 d | A | d1 | d2 | B | L | L1 | L2 | L3 | L4 | L5 |
|--------|---------------|-------|------|------|------|----|------|------|------|------|------|------|
| | PDWTL-3.2A-R | 3.2 | R1/8 | 2.3 | 4.8 | 12 | 41.5 | 23.7 | 13 | 28.5 | 17.8 | 17 |
| | PDWTL-3.2B-R | 3.2 | R1/4 | 2.3 | 4.8 | 12 | 48.1 | 24.7 | 13 | 35.1 | 23.4 | 18 |
| | PDWTL-6.35A-R | 6.35 | R1/8 | 4.8 | 4.8 | 14 | 45.8 | 27 | 15.4 | 30.4 | 18.8 | 19.6 |
| | PDWTL-6.35B-R | 6.35 | R1/4 | 4.8 | 4.8 | 14 | 50.4 | 27 | 15.4 | 35 | 23.4 | 19.6 |
| | PDWTL-6.35C-R | 6.35 | R3/8 | 4.8 | 4.8 | 14 | 56 | 29.8 | 15.4 | 40.6 | 26.2 | 22.4 |
| | PDWTL-6.35D-R | 6.35 | R1/2 | 4.8 | 4.8 | 14 | 64.8 | 31.8 | 15.4 | 49.4 | 33 | 24.4 |
| | PDWTL-9.52A-R | 9.52 | R1/8 | 7.1 | 4.8 | 17 | 51.5 | 30.7 | 17.2 | 34.3 | 20.8 | 23.1 |
| | PDWTL-9.52B-R | 9.52 | R1/4 | 7.1 | 7.1 | 17 | 56.1 | 30.7 | 17.2 | 38.9 | 25.4 | 23.1 |
| | PDWTL-9.52C-R | 9.52 | R3/8 | 7.1 | 7.1 | 17 | 61.7 | 33.5 | 17.2 | 44.5 | 28.2 | 25.9 |
| | PDWTL-9.52D-R | 9.52 | R1/2 | 7.1 | 7.1 | 17 | 66.5 | 33.5 | 17.2 | 49.3 | 33 | 25.9 |
| | PDWTL-12.7A-R | 12.7 | R1/8 | 10.4 | 4.8 | 22 | 59.8 | 36.2 | 23 | 36.8 | 23.6 | 25.9 |
| | PDWTL-12.7B-R | 12.7 | R1/4 | 10.4 | 7.1 | 22 | 64.4 | 36.2 | 23 | 41.4 | 28.2 | 25.9 |
| | PDWTL-12.7C-R | 12.7 | R3/8 | 10.4 | 9.7 | 22 | 64.6 | 36.4 | 23 | 41.6 | 28.2 | 25.9 |
| | PDWTL-12.7D-R | 12.7 | R1/2 | 10.4 | 10.4 | 22 | 69.4 | 36.4 | 23 | 46.4 | 33 | 25.9 |

※NPTねじ (アメリカ管用ねじ) も製作しております。