

# MALE ELBOW

## エルボーフユニオン(Rねじ)

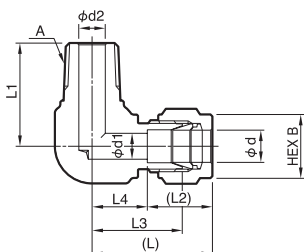

| ミリサイズ | 品番          | 呼び径 d | A    | d1  | B  | L    | L1   | L2   | L3   | L4   |
|-------|-------------|-------|------|-----|----|------|------|------|------|------|
|       | PDWL-3A-R   | 3     | R1/8 | 2.4 | 10 | 23.4 | 17.8 | 12.7 | 17   | 10.7 |
|       | PDWL-3B-R   | 3     | R1/4 | 2.4 | 10 | 24.4 | 23.4 | 12.7 | 18   | 11.7 |
|       | PDWL-4A-R   | 4     | R1/8 | 2.4 | 12 | 25.3 | 18.8 | 13.6 | 18.8 | 11.7 |
|       | PDWL-4B-R   | 4     | R1/4 | 2.4 | 12 | 25.3 | 23.4 | 13.6 | 18.8 | 11.7 |
|       | PDWL-6A-R   | 6     | R1/8 | 4.8 | 14 | 26.8 | 18.8 | 15.2 | 19.6 | 11.6 |
|       | PDWL-6B-R   | 6     | R1/4 | 4.8 | 14 | 26.8 | 23.4 | 15.2 | 19.6 | 11.6 |
|       | PDWL-6C-R   | 6     | R3/8 | 4.8 | 14 | 29.6 | 26.2 | 15.2 | 22.4 | 14.4 |
|       | PDWL-6D-R   | 6     | R1/2 | 4.8 | 14 | 31.6 | 33   | 15.2 | 24.4 | 16.4 |
|       | PDWL-8A-R   | 8     | R1/8 | 4.8 | 16 | 28.8 | 19.8 | 16.2 | 21.3 | 12.6 |
|       | PDWL-8B-R   | 8     | R1/4 | 6.4 | 16 | 28.8 | 24.4 | 16.2 | 21.3 | 12.6 |
|       | PDWL-8C-R   | 8     | R3/8 | 6.4 | 16 | 30.6 | 26.2 | 16.2 | 23.1 | 14.4 |
|       | PDWL-8D-R   | 8     | R1/2 | 6.4 | 16 | 32.6 | 33   | 16.2 | 25.1 | 16.4 |
|       | PDWL-10A-R  | 10    | R1/8 | 4.8 | 19 | 33.3 | 23.6 | 17   | 25.9 | 16.3 |
|       | PDWL-10B-R  | 10    | R1/4 | 7.1 | 19 | 33.3 | 28.2 | 17   | 25.9 | 16.3 |
|       | PDWL-10C-R  | 10    | R3/8 | 7.9 | 19 | 33.3 | 28.2 | 17   | 25.9 | 16.3 |
|       | RPDWL-10D-R | 10    | R1/2 | 7.9 | 19 | 33.3 | 33   | 17   | 25.9 | 16.3 |
|       | RPDWL-12A-R | 12    | R1/8 | 4.8 | 22 | 35.7 | 23.6 | 22.5 | 25.9 | 13.2 |
|       | PDWL-12B-R  | 12    | R1/4 | 7.1 | 22 | 35.7 | 28.2 | 22.5 | 25.9 | 13.2 |
|       | PDWL-12C-R  | 12    | R3/8 | 9.5 | 22 | 35.7 | 28.2 | 22.5 | 25.9 | 13.2 |
|       | PDWL-12D-R  | 12    | R1/2 | 9.5 | 22 | 35.7 | 33   | 22.5 | 25.9 | 13.2 |

※NPTねじ (アメリカ管用ねじ) も製作しております。

| インチサイズ | 品番           | 呼び径 d | A    | d1   | B  | L    | L1   | L2   | L3   | L4   |
|--------|--------------|-------|------|------|----|------|------|------|------|------|
|        | PDWL-3.2A-R  | 3.2   | R1/8 | 2.3  | 12 | 23.7 | 17.8 | 13   | 17   | 10.7 |
|        | PDWL-3.2B-R  | 3.2   | R1/4 | 2.3  | 12 | 24.7 | 23.4 | 13   | 18   | 11.7 |
|        | PDWL-6.35A-R | 6.35  | R1/8 | 4.8  | 14 | 27   | 18.8 | 15.4 | 19.6 | 11.6 |
|        | PDWL-6.35B-R | 6.35  | R1/4 | 4.8  | 14 | 27   | 23.4 | 15.4 | 19.6 | 11.6 |
|        | PDWL-6.35C-R | 6.35  | R3/8 | 4.8  | 14 | 29.8 | 26.2 | 15.4 | 22.4 | 14.4 |
|        | PDWL-6.35D-R | 6.35  | R1/2 | 4.8  | 14 | 31.8 | 33   | 15.4 | 24.4 | 16.4 |
|        | PDWL-9.52A-R | 9.52  | R1/8 | 4.8  | 17 | 30.7 | 20.8 | 17.2 | 23.1 | 13.5 |
|        | PDWL-9.52B-R | 9.52  | R1/4 | 7.1  | 17 | 30.7 | 25.4 | 17.2 | 23.1 | 13.5 |
|        | PDWL-9.52C-R | 9.52  | R3/8 | 7.1  | 17 | 31.5 | 26.2 | 17.2 | 23.9 | 14.3 |
|        | PDWL-9.52D-R | 9.52  | R1/2 | 7.1  | 17 | 33.5 | 33   | 17.2 | 25.9 | 16.3 |
|        | PDWL-12.7A-R | 12.7  | R1/8 | 4.8  | 22 | 36.2 | 23.6 | 23   | 25.9 | 13.2 |
|        | PDWL-12.7B-R | 12.7  | R1/4 | 7.1  | 22 | 36.2 | 28.2 | 23   | 25.9 | 13.2 |
|        | PDWL-12.7C-R | 12.7  | R3/8 | 9.7  | 22 | 36.2 | 28.2 | 23   | 25.9 | 13.2 |
|        | PDWL-12.7D-R | 12.7  | R1/2 | 10.4 | 22 | 36.2 | 33   | 23   | 25.9 | 13.2 |

※NPTねじ (アメリカ管用ねじ) も製作しております。