

超硬

AHTBE

切削条件表

P335

超硬エアホール ソリッドテーパボールエンドミル Carbide Airhole Solid Taper Ball End Mill

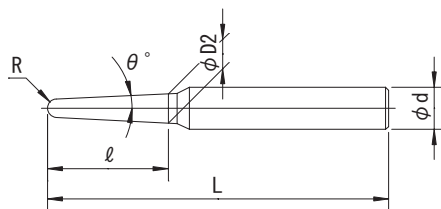

公差 (Tolerance)	R: ±0.02	θ: ±5'	d: h6
----------------	----------	--------	-------

右刃右ネジレ30° 刃数:2 K10
Helix Angle-Right30° Number of Flute:2 Micro Grain Carbide

寸法 R	片角 (θ) Taper Angle	刃長 (ℓ) Cut Length	大径 (ΦD2) Diameter at Large End	全長 (L) Overall Length	シャンク径 (Φd) Shank Dia.
2	30'	25	4.4	90	6
	1°	25	4.8	90	6
	1° 30'	25	5.2	90	6
	2°	25	5.6	90	6
	2° 30'	25	6.01	90	6
	3°	25	6.41	90	6
	5°	25	8.03	90	8
	7°	25	9.67	90	10
2.5	30'	35	5.56	100	6
	1°	35	6.13	100	6
	1° 30'	35	6.7	100	6
	2°	35	7.27	100	6
	2° 30'	35	7.84	100	8
	3°	35	8.41	100	8
	5°	35	10.7	100	10
	7°	35	13.01	100	12
3	30'	35	6.55	100	6
	1°	35	7.11	100	6
	1° 30'	35	7.67	100	6
	2°	35	8.23	100	8
	2° 30'	35	8.8	100	8
	3°	35	9.36	100	8
	5°	35	11.62	100	12
	7°	35	13.9	100	12

寸法 R	片角 (θ) Taper Angle	刃長 (ℓ) Cut Length	大径 (ΦD2) Diameter at Large End	全長 (L) Overall Length	シャンク径 (Φd) Shank Dia.
4	30'	40	8.62	100	8
	1°	40	9.25	100	8
	1° 30'	40	9.88	100	10
	2°	40	10.51	100	10
	2° 30'	40	11.15	100	10
	3°	40	11.78	100	12
	5°	40	14.32	100	12
	7°	40	16.9	100	16
5	30'	50	10.78	120	10
	1°	50	11.57	120	10
	1° 30'	50	12.36	120	12
	2°	50	13.14	120	12
	2° 30'	50	13.93	120	12
	3°	50	14.73	120	12
	5°	50	17.91	120	16
	7°	50	21.12	120	20
6	30'	50	12.76	120	12
	1°	50	13.53	120	12
	1° 30'	50	14.3	120	12
	2°	50	15.08	120	12
	2° 30'	50	15.85	120	16
	3°	50	16.62	120	16
	5°	50	19.74	120	20
	7°	50	22.89	120	20