

## Angled socket XELW-4

For mounting on printed circuit boards, touch-protected according to IEC/EN 61010-1. The socket is directly soldered onto printed circuit boards.

The right-angled configuration minimizes the force transmitted to the printed circuit board through the plugged-in test lead. Right-angled Ø 4 mm rigid socket accept-

ing spring-loaded Ø 4 mm plugs with rigid insulating sleeve. Machined brass. **Connection: Ø 2 mm round pin and contacts for mounting on printed circuit boards.**

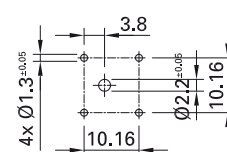
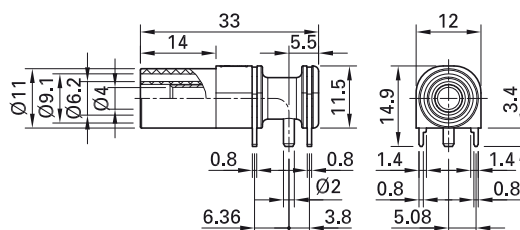

Panel drilling

Order No.	Type	Rated voltage/current		*Standard colors
66.9040-*	XELW-4	1000 V, CAT III / 24 A 600 V, CAT IV / 24 A	Au c RU US	21 22 23



Assembly instructions MAH561

[www.staubli.com/electrical](http://www.staubli.com/electrical)



Optional colors 24

Further information, page 6

## Angled socket SLB4-I/90

Insulated, right-angled Ø 4 mm rigid socket accepting spring-loaded Ø 4 mm plugs with rigid insulating sleeve. Machined brass.

**Connection: Ø 2 mm round pin and contacts for mounting on printed circuit boards.**

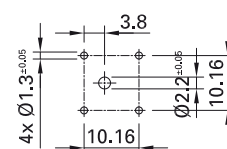
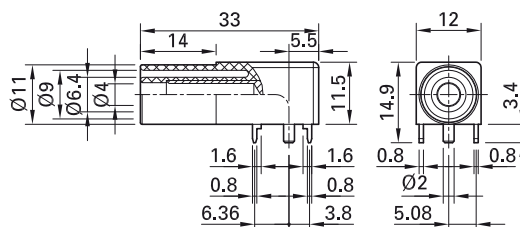
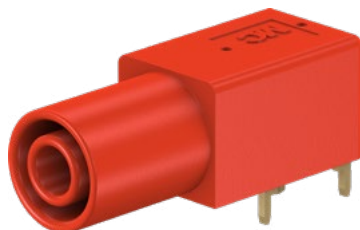

Panel drilling

Order No.	Type	Rated voltage/current		*Standard colors
23.3200-*	SLB4-I/90	1000 V, CAT III / 24 A	Au	21 22



Optional colors 23 24 25

Further information, page 6