

A-MAR/A-MASR Series

중/고하중 방진형
Medium & Heavy Duty Cushioning Type

FEATURES

- 단조 후 가공품으로 중고하중용 바닥경사면에 사용하며 방진 및 미끄럼 방지형
- Medium & heavy duty purpose with mechanical working after forging, slope floor, anti-vibration, anti-slip

APPLICATION

콘베어, 공작기계, 자동화설비
Conveyor, Construction machine, Automatic facilities.

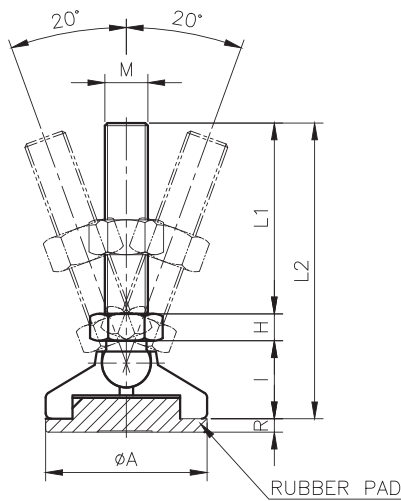

ORDERING CODE

A	M	A	S	R	12	60
AUTOCFT LEVELLING FOOT	MECHANICAL WORKING	ANGLE	S : STAINLESS (BOLT, NUT) Blank : STEEL	RUBBER	SCREW DIA (mm)	SCREW LENGTH (mm)

DIMENSION & MATERIAL

MODEL	DIMENSIONS (mm)							MATERIALS			허용하중 (kg/4EA)	표면처리 Treatments
	L1	L2	H	I	A	R	M	Bolt & Nut	Cup	Pad		
A-MAR-12 A-MASR-12	60 90	102 132	8	29	Ø60	5	M12×1.75	S10C SUS304	S45C SUS304	NBR	1000	니켈도금 (Ni)
A-MAR-16 A-MASR-16	100 130 150 180 200	154 / 144 184 / 174 204 / 194 234 / 224 254 / 244	10	29 34	Ø60 Ø78	5 10	M16×2.0	S10C SUS304	S45C SUS304	NBR	2000	니켈도금 (Ni)
A-MAR-20 A-MASR-20	100 130 150 180 200	157 187 207 237 257	13	34	Ø78	10	M20×2.5	S10C SUS304	S45C SUS304	NBR	3000	니켈도금 (Ni)
A-MAR-24 A-MASR-24	150 200	211 261	14	37	Ø98	10	M24×3.0	S10C SUS304	S45C SUS304	NBR	4000	니켈도금(Ni) 무전해니켈(E-Ni)
A-MAR-30 A-MASR-30	150 200	215 265	18	37	Ø98	10	M30×3.5	S10C SUS304	S45C SUS304	NBR	5000	니켈도금(Ni) 무전해니켈(E-Ni)